

# STEEL HOUSE FRAMES

## TECHNICAL BULLETIN TB-34

Rev 2, SEP 2009

This issue supersedes all previous issues

### INTRODUCTION

This bulletin has been written to assist designers, builders and homeowners to realise the benefits of frames made from TRUECORE® steel. The coating of TRUECORE® steel complies with the durability requirements of the Building Code of Australia (BCA) Volume 2 Part 3.4.2.2.

Only general information is provided in this bulletin and this is not a substitute for professional advice. BlueScope Steel recommends that you seek specific advice regarding the needs of your project.

### ENVIRONMENT

Residential framing made from TRUECORE® steel should be erected greater than 300 metres from the high water mark of "surf" and/or "exposed" salt marine influences or greater than 100 metres from the high water mark of "calm" salt marine or brackish influence. Refer TB-35 'Australian Salt Marine Classifications' for definitions and some examples.

### HANDLING AND SITE STORAGE

As with all building materials, care should be exercised when handling and storing frames and trusses made from TRUECORE® steel.

Suitable gloves should always be worn when handling framing material. Framing material should be handled in a manner suitable to protect the coating and to avoid any adverse effects on product performance.

Minor scratches are unlikely to affect product performance, however if the coating is accidentally damaged and needs repair (see *Technical Bulletin TB-10 - Cut edge protection of zinc-coated and zinc/aluminium alloy-coated steel*), the affected area can be treated by the application of a zinc rich paint designed for this purpose.

Whilst TRUECORE® steel is a durable framing material, frames and trusses made from TRUECORE® steel should be kept dry during storage and erection. Frames and trusses should be stored on a flat, even surface and other loads not placed on top. It is good practice to keep exposure to the weather during the building process to a minimum.

### TERMITE CONSIDERATIONS

The BCA is the principal source document that governs how buildings can be built in Australia and Volume 2 Part 3.1.3 (subject to specific State or local council regulations), clearly recognizes that if primary building elements are made from steel, no termite barrier is required. Termites and borers cannot eat steel.

The National Association of Steel-framed Housing (NASH) commissioned a study on the risk of termite infestation in steel framed and timber framed houses - Prof. A P Jeary of the University of Western Sydney in 2003. There was no incidence of steel frame houses suffering termite damage in this study thus providing peace of mind when choosing a steel frame.



### WALL FRAMES

#### Use a Membrane

An impermeable membrane should be installed under all perimeter bottom plates fixed to concrete slabs on ground. The membrane should also extend up the weather side flange of the bottom plate (see *Figures 1 and 2*). This is consistent with good building practice and is a condition of BlueScope Steel's warranty on house framing made from TRUECORE® steel.

When a frame is fixed to a suspended floor, an impermeable membrane below the wall frame is not required to protect the wall from ground moisture if adequate sub-floor ventilation is supplied and a minimum distance of 400mm is allowed between the underside of the floor framing and existing ground level. (The protection of internal bottom plates is not considered necessary. For "wet areas" refer to Australian Standard AS 3470). The type of membrane used should be "impermeable to moisture".

**Figure 1:** Deep Edge Rebates

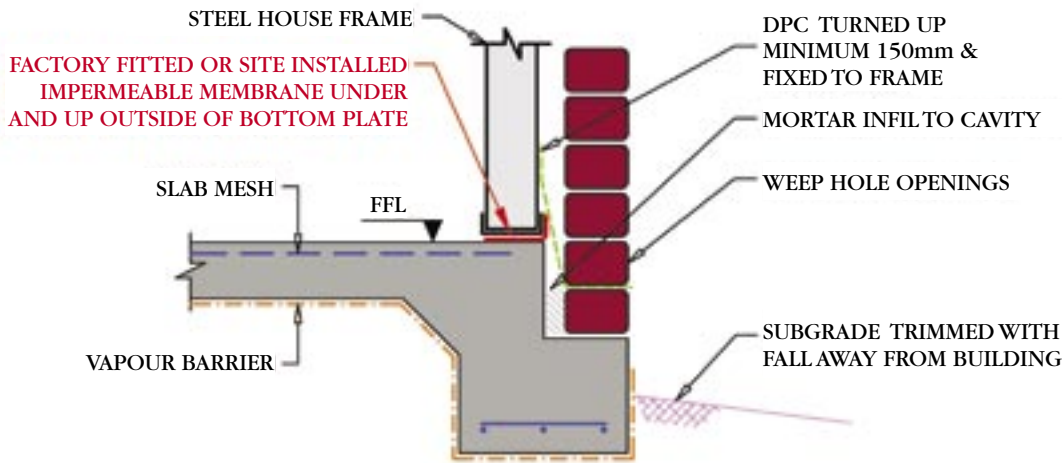

**PROPOSED REBATE SYSTEM**

**Note:** Beam reinforcement shall be designed to suit soil classification.  
**Note:** Termite management treatments have been omitted for clarity.

Suitable impervious membranes include:

- Bitustik / Bituthene® 2000 by Grace Construction Products,
- Polyethylene and other products specified in BCA Volume 2, Part 3.3.4.4
- Brushable Hydrosel from Tremco
- Kordon Termite Barrier (see manufacturer’s specification for detail).

The protection of the weather side flange (see Figure 1) is necessary because this part of the frame is subject to moist air movement from the lower parts of the cavity as it tries to evaporate and move past the masonry damp-proof course.

**Earth the Frame**

For safety reasons, your house frame made from TRUECORE® steel should be temporarily earthed during erection. At the first opportunity your electrician should follow local electricity supply authority regulations and effectively earth the completed building frame via a connection to the main earth bar of the house switchboard.

**Incompatible Materials**

Materials considered incompatible in direct contact with framing components made from TRUECORE® steel include:

- copper
  - lead
  - brass
  - stainless steel
  - treated timber, green timber and other timber capable of retaining moisture.
- NOTE - frames made from TRUECORE® steel should be isolated from contact with treated, green or moist timber unless

specific written advice has been obtained from BlueScope Steel.

- washers containing significant amounts of carbon black eg. neoprene.
- in general, mortar splashes don’t pose any corrosion problems if kept dry. However, if the mortar forms a continuous bridge between the brick veneer wall or slab and the TRUECORE® steel frame, it may lead to corrosion of the steel frame via moisture “wicking”.

Incompatible components should be isolated from frames or trusses.

The use of incompatible materials will void your warranty. See *Corrosion Technical Bulletin CTB-12 - Dissimilar Metals and Corrosion Technical Bulletin CTB-13 - Contact with Timber*

**ROOF TRUSSES**

It is a condition of BlueScope Steel’s warranty that roof trusses are completely enclosed within the building envelope, as described in the warranty terms and conditions. Dwellings with exposed eaves will NOT be eligible for a TRUECORE® steel framing warranty.

Building design and detailing should aim to minimise the ingress of any salt-laden or moist air, particularly for homes in close proximity, within 1km or so, to surf or exposed marine influences (refer TB-35 “Australian Salt Marine Classifications”). Avoid areas of exposed but unwashed framing material (see *Corrosion Technical Bulletin CTB-8 - Building Applications*).



**Figure 2:** Shallow Edge Rebates

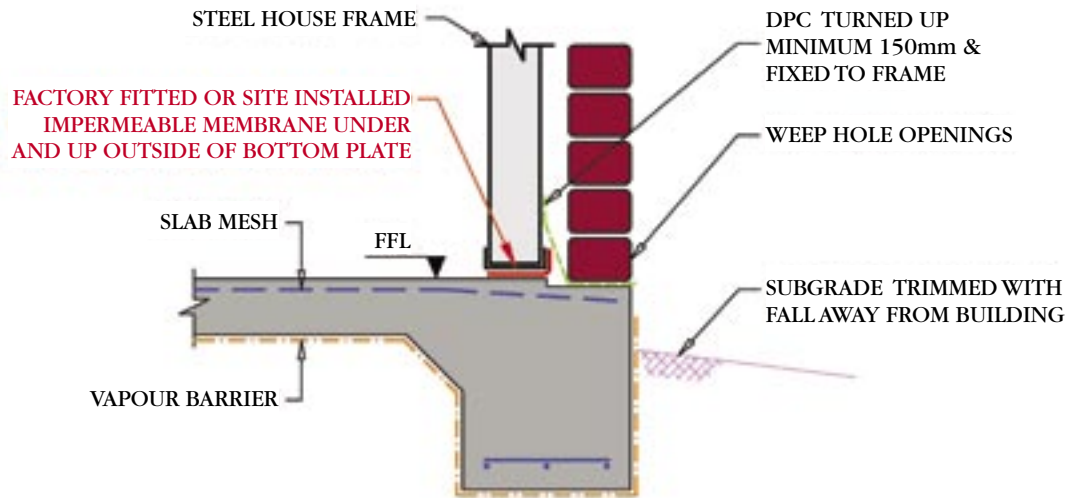

### PROPOSED REBATE SYSTEM

**Note:** Beam reinforcement shall be designed to suit soil classification.

**Note:** Termite management treatments have been omitted for clarity.

#### **WALL INSULATION**

House framing made from TRUECORE® steel offers many advantages, including tight dimensional tolerances, which can assist in achieving good insulation. One example of how tight tolerances can help is by reducing air leakage between the frame and insulating materials when heating a home in a cool climate.

Bulk insulation materials are commonly used with wall frames made from TRUECORE® steel. When insulating steel wall frames in cold climates or when building with cladding materials with low thermal resistance, such as metal, plastic or fibre-cement sheeting, then rigid board or sheathing-type insulation products are recommended. These products are not bridged by the frame so do not lose any of their insulating properties. If using bulk insulation with steel framing and lightweight cladding, batten the cladding out from the framing or use a thermal break between the stud and the cladding, such as thin expanded polystyrene strips. This will ensure good thermal performance and condensation control around the framing.

#### **WALL TIES**

Sometimes a forgotten structural component, the choice of wall ties can be important to the structural performance of a building frame. Galvanized wall ties are suitable for use with steel framing in most situations, although more durable ties may be needed within 1km from breaking surf and heavy industrial areas, refer BCA Volume 2, Table 3.3.3.1.

Polymer wall ties are now available and should provide good performance with a steel building frame in all environments.

Stainless steel wall ties, if used, must be insulated from the framing material to avoid the possibility of corrosion resulting from the use of incompatible dissimilar metals.

#### **PHONE / RADIO RECEPTION**

A steel frame should not affect your telephone, wireless computer network, radio or mobile phone or television reception.

#### **NOISE**

A study published by CSIRO (G A King, Dr. M Ridge and G S Walker - in Building Materials and Equipment, Vol. 17, No. 1) has concluded that steel framed houses are no “noisier” than houses with other types of frames. Whether a steel frame is mechanically jointed or welded, movement caused by changes in temperature should not cause significant noise in a properly constructed and insulated home.

#### **FASTENERS**

The correct choice of fastener is critical to long-term performance when fixing premium steel products. Fasteners used to fix your steel framing should conform to AS3566 Class 3, with the exception that Class 4 fasteners should be used at less than 400m from the high water mark of “surf “ or “exposed” salt marine influences. Do not use stainless steel fasteners with steel framing made from TRUECORE® steel.

Rivets and bolts used to secure framing made from TRUECORE® steel should conform with relevant standards, be compatible with and have equivalent durability to TRUECORE® steel.

*NOTE - welded areas must be treated by the application of a zinc rich paint to ensure weld affected area has equivalent performance to remainder of TRUECORE® steel frame.*

## LIGHTNING

As mentioned previously, steel frames are earthed and therefore this provides a direct path for the energy in the unlikely event of a lightning strike.

## WARRANTY

A 50-year warranty is available on application for residential framing made from TRUECORE® steel.

To be eligible for a warranty, the frame made from TRUECORE® steel must be erected greater than 300 metres from the high water mark of "surf" and/or "exposed" salt marine influences or greater than 100 metres from the high water mark of "calm" salt marine or brackish influence and installed in accordance with the requirements of the warranty and/or TB 34 requirements.

If you have any questions regarding this bulletin and for a copy of the full Warranty terms and conditions please contact your local BlueScope Steel office or BlueScope Steel Direct on 1800 800 789 or visit [www.truecore.com.au](http://www.truecore.com.au)

## RELATED BLUESCOPE STEEL TECHNICAL BULLETINS:

**Technical Bulletin TB-10** - Cut edge protection of zinc-coated and zinc/aluminium alloy coated steel.

**Technical Bulletin TB-16** - Fasteners For Roofing and Walling Product – Selection Guide

**Technical Bulletin TB-35** - Australian Salt Marine Classifications

**Corrosion Technical Bulletin CTB-8** - Building Applications

**Corrosion Technical Bulletin CTB-12** - Dissimilar Metals

**Corrosion Technical Bulletin CTB-13** - Contact with Timber

The information and advice contained in this Bulletin is of a general nature only, and has not been prepared with your specific needs in mind. You should always obtain specialist advice to ensure that the materials, approach and techniques referred to in this Bulletin meet your specific requirements.

BlueScope Steel Limited makes no warranty as to the accuracy, completeness or reliability of any estimates, opinions or other information contained in this Bulletin, and to the maximum extent permitted by law, BlueScope Steel Limited disclaims all liability and responsibility for any loss or damage, direct or indirect, which may be suffered by any person acting in reliance on anything contained in or omitted from this document.

TRUECORE® is a registered trade mark of BlueScope Steel Limited.  
BlueScope is a registered trade mark of BlueScope Steel Limited.

*Please ensure you have the current Technical Bulletin as displayed at [www.bluescopesteel.com.au](http://www.bluescopesteel.com.au)*

## BlueScope Steel

Copyright 2009 BlueScope Steel Limited  
BlueScope Steel Limited ABN 16 000 011 058  
BlueScope Steel (AIS) Pty Ltd ABN 19 000 019 625

**BlueScope Steel Direct on 1800 800 789 or +61 2 4222 4300 for international enquiries.**

